

FOR LEASE | 5113 N. Executive Drive

ASKING RATE: \$15/SF



EXECUTIVE SUMMARY

REMAX Traders Unlimited has been exclusively retained to lease suite 104 in 5133 N. Executive Drive – a turnkey office building located in a desirable professional park off Glen Avenue conveniently between the University Street and Knoxville Avenue intersections in Peoria, IL. **Most tenants share common restrooms, but there are suites available with private restrooms.** The property is zoned OT. Please reach out to listing agents for additional information.



4,195
AVAILABLE
SF



NET
LEASE TYPE



1
AVAILABLE
UNIT



OT
ZONING

CLICK FOLDER FOR LINK TO

- Property Photos & Videos
- Floorplans



JUSTIN BALL
JUSTIN.BALL@REMAX.NET
309.323.0399

JESSICA BALL
JESSICABALL@REMAX.NET
309.363.2929

MICHAEL KOLBUS
MKOLBUS@REMAX.NET
309.258.7746

RE/MAX
COMMERCIAL
TRADERS UNLIMITED

FOR LEASE | 5113 N. Executive Drive

AVAILABLE SUITES

SUITE	SIZE (SF)	B A S E / S F	EST NNN / SF	NOTES
104	4,195	\$ 1 5 . 0 0	\$5.36	Rare private entrance & restroom as well as a private deck. The suite has 2-3 offices with reception or waiting area. Space could include additional offices and square feet or be divided into micro-suites to meet your needs. In addition to the suite's private restroom, tenant and guests will also have access to the common area restrooms in the building.



JUSTIN BALL
JUSTIN.BALL@REMAX.NET
309.323.0399

JESSICA BALL
JESSICABALL@REMAX.NET
309.363.2929

MICHAEL KOLBUS
MKOLBUS@REMAX.NET
309.258.7746

RE/MAX
COMMERCIAL®
TRADERS UNLIMITED

FOR LEASE | 5113 N. Executive Drive

EXTERIOR PICTURES



JUSTIN BALL
JUSTIN.BALL@REMAX.NET
309.323.0399

JESSICA BALL
JESSICABALL@REMAX.NET
309.363.2929

MICHAEL KOLBUS
MKOLBUS@REMAX.NET
309.258.7746

RE/MAX
COMMERCIAL
TRADERS UNLIMITED

FOR LEASE | 5113 N. Executive Drive

INTERIOR PICTURES – SUITE 104



MIKE O'BRYAN
309.323.0399

JUSTIN BALL
JUSTIN.BALL@REMAX.NET
309.323.0399

JESSICA BALL
JESSICABALL@REMAX.NET
309.363.2929

MICHAEL KOLBUS
MKOLBUS@REMAX.NET
309.258.7746

RE/MAX
COMMERCIAL
TRADERS UNLIMITED

FOR LEASE | 5113 N. Executive Drive

FLOORPLAN - 1st Floor



JUSTIN BALL
JUSTIN.BALL@REMAX.NET
309.323.0399

JESSICA BALL
JESSICABALL@REMAX.NET
309.363.2929

MICHAEL KOLBUS
MKOLBUS@REMAX.NET
309.258.7746

RE/MAX
COMMERCIAL®
TRADERS UNLIMITED

FOR LEASE | 5113 N. Executive Drive

FLOORPLAN – 2nd Floor



MIKE O'BRYAN
309.323.0399

JUSTIN BALL
JUSTIN.BALL@REMAX.NET
309.323.0399

JESSICA BALL
JESSICABALL@REMAX.NET
309.363.2929

MICHAEL KOLBUS
MKOLBUS@REMAX.NET
309.258.7746

RE/MAX
COMMERCIAL
TRADERS UNLIMITED

FOR LEASE | 5113 N. Executive Drive

FLOORPLAN – Lower Floor

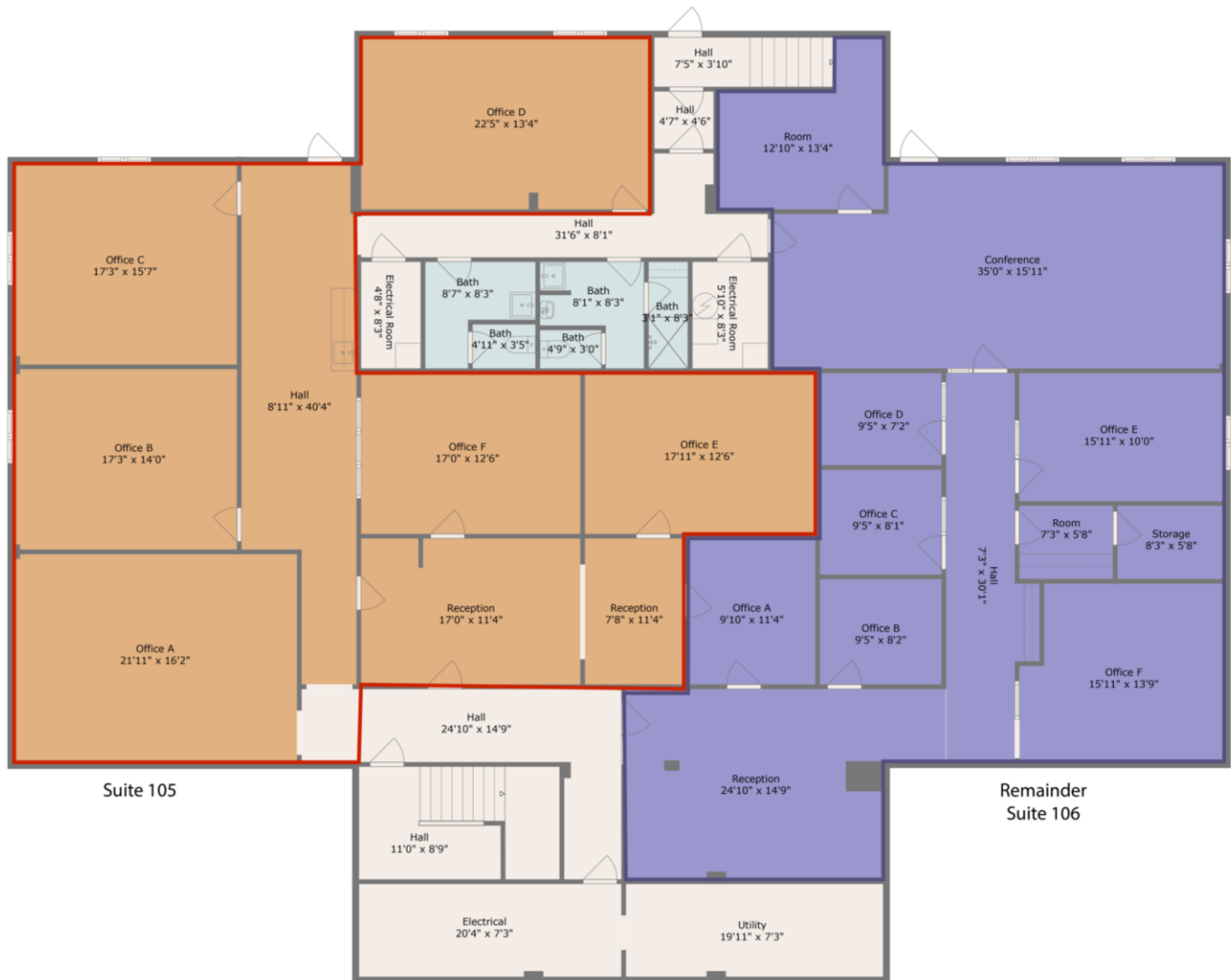

JUSTIN BALL
JUSTIN.BALL@REMAX.NET
309.323.0399

JESSICA BALL
JESSICABALL@REMAX.NET
309.363.2929

MICHAEL KOLBUS
MKOLBUS@REMAX.NET
309.258.7746

RE/MAX
COMMERCIAL®
TRADERS UNLIMITED

AREA DEMOGRAPHICS

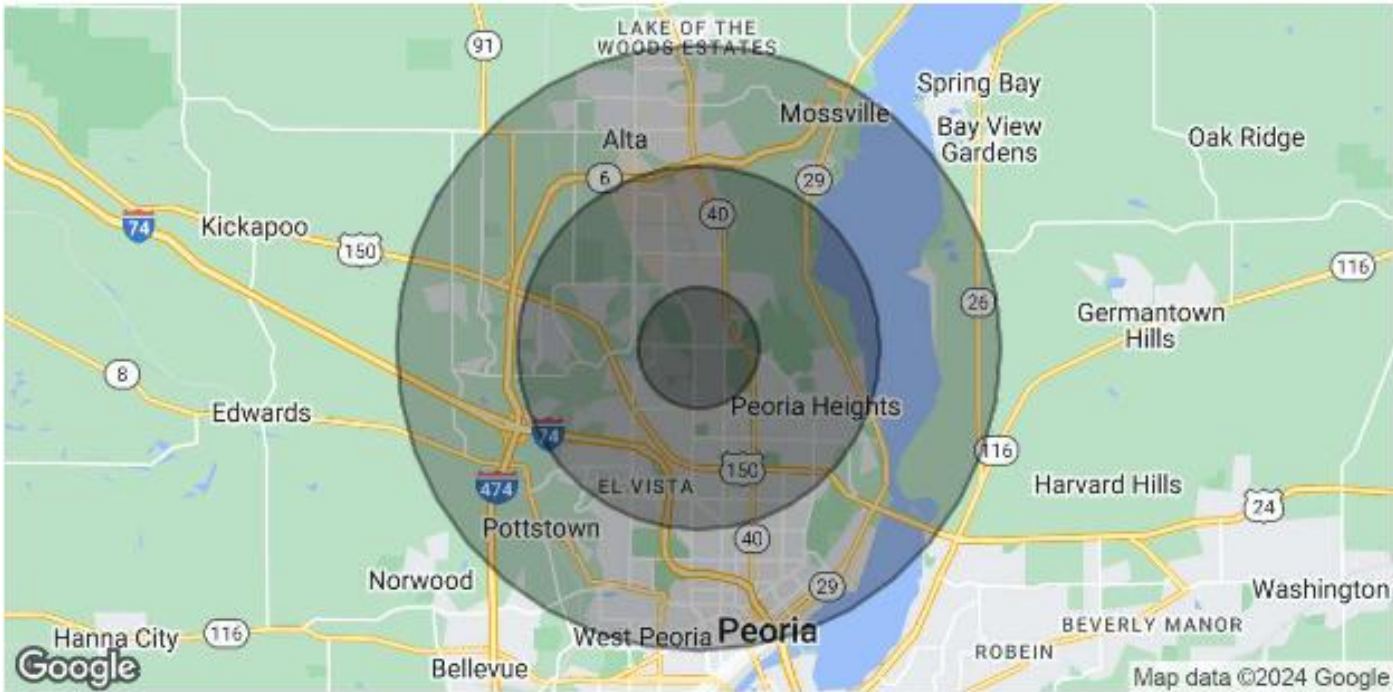

POPULATION	1 MILE	3 MILES	5 MILES
Total Population	7,961	56,008	112,408
Average Age	43	42	40
Average Age (Male)	41	40	38
Average Age (Female)	45	44	41

HOUSEHOLDS & INCOME	1 MILE	3 MILES	5 MILES
Total Households	3,613	25,801	48,171
# of Persons per HH	2.2	2.2	2.3
Average HH Income	\$81,064	\$79,136	\$84,840
Average House Value	\$184,218	\$167,525	\$177,845

Demographics data derived from AlphaMap

JUSTIN BALL
JUSTIN.BALL@REMAX.NET
309.323.0399

JESSICA BALL
JESSICABALL@REMAX.NET
309.363.2929

MICHAEL KOLBUS
MKOLBUS@REMAX.NET
309.258.7746

RE/MAX
COMMERCIAL
TRADERS UNLIMITED



5113 N Executive Drive
PEORIA, IL 61614

RE/MAX
COMMERCIAL®

TRADERS UNLIMITED



JUSTIN BALL
Broker, REALTOR
Tel: (309) 323-0399
Justin.Ball@Remax.net
Lic #475.175281



JESSICA BALL
Broker, REALTOR
Tel: (309) 363-2929
JessicaBall@Remax.net
Lic #475.175281



MICHAEL KOLBUS
Broker, REALTOR
Tel: (309) 258-7746
MKolbus@Remax.net
Lic #475.213462

All information contained herein is deemed reliable but not guaranteed.
Each office is independently owned and operated.
Office: 3622 N Knoxville Avenue, Peoria, IL 61603